



*Where Quality Meets Expectations*

**1000+**  
SATISFIED  
CUSTOMERS



# **Global Leader in Khakhra Making Machinery**

**"Innovation. Quality. Service."**

AN ISO 9001 : 2015 CERTIFIED COMPANY



## COMPANY OVERVIEW

**Qualimark Machines Pvt. Ltd.** is a progressively-growing company, established in 2001, famous for introducing innovative and path-breaking products such as India's first Hydraulic-based **Khakhra Making Machine** and Single Conveyer Technology-based **Automatic Chapati Making Machine**. An **ISO 9001:2015-certified company**, Qualimark designs, manufactures and exports the technologically-superior and highly-successful khakhra & chapati making machines and other innovative machines for food processing industry, all over the world.



One of the main things which differentiate us from others is that we are a purely innovation-driven company, having our **manufacturing unit & state of the art R&D center spread over 45,000 sq.ft.** We rigorously develop and upgrade our product range to bring ground breaking innovations and supply world-class products that solve problems for our customers. We promise innovative high tech products characterized by tremendous quality and reliability. Continuous development work helps customers to maximize their competitive ability. By choosing Qualimark, **you can also profit from 22 years of Qualimark technological leadership in Khakhra & Chapati making machinery.**

We endeavor to keep preserving on our conventional power and fulfilling our vision of becoming a global leader, keen towards professionalism and superiority while striving to promise the highest level of satisfaction for our clients. The company is continuously rising on growth charts and setting high standards for quality.

Maintaining a **"Customer First"** attitude by investing in delivering quality products, service and value to customers Qualimark continues to touch people's lives by solving problems. We believe in integrity, consistency, innovation and customer focus and this has earned us priceless goodwill in the domestic and international market.

We are delighted to introduce you to the **world of Qualimark**, a company **Where Quality Meets Expectations!**



Qualimark holds cutting edge manufacturing and R&D facility in its main manufacturing unit located at Vadodara, Gujarat. The necessary manufacturing facilities with latest machineries are installed in the company.



## AWARDS & RECOGNITIONS

Qualimark has won the prestigious **GUJARAT GOVERNMENT 'Best MSME Award'** for the category of "Innovation in Technology" for the year 2015.



Qualimark has been awarded the renowned **'Global Achievers Award'** for Business Excellence Category in 35th Indian Achiever's Summit 2013.



Qualimark has been awarded for **Best Management** category by **Foodmech Asia**



### VISION

Qualimark envisions contributing significantly to the food processing industry by providing reliable machines that solve food processing problems of users effortlessly and promise optimum levels of output. Through constant innovation, groundbreaking products and superior service quality, Qualimark seeks to become the leader in khakhra making & chapati making machinery domain in the near future.

### MISSION

Our mission is to delight end-consumers with innovative and high-quality food processing machinery and high-standards of customer service. Believing in the power of continuous innovation, Qualimark aims to develop the most reliable range of innovative products that offers amazing convenience and delightful experience to the users.

### STRATEGY

Qualimark believes in creating a positive outlook among the minds of consumers by employing an insightful business strategy focused around leveraging the benefits of differentiation, customization, innovation and superior service delivery. Our focused research and development approach help us in improving existing product offerings and introducing fresh range of products on a regular basis.

## CERTIFICATIONS & STANDARDS





# FULLY AUTOMATIC KHAKHRA MAKING MACHINE

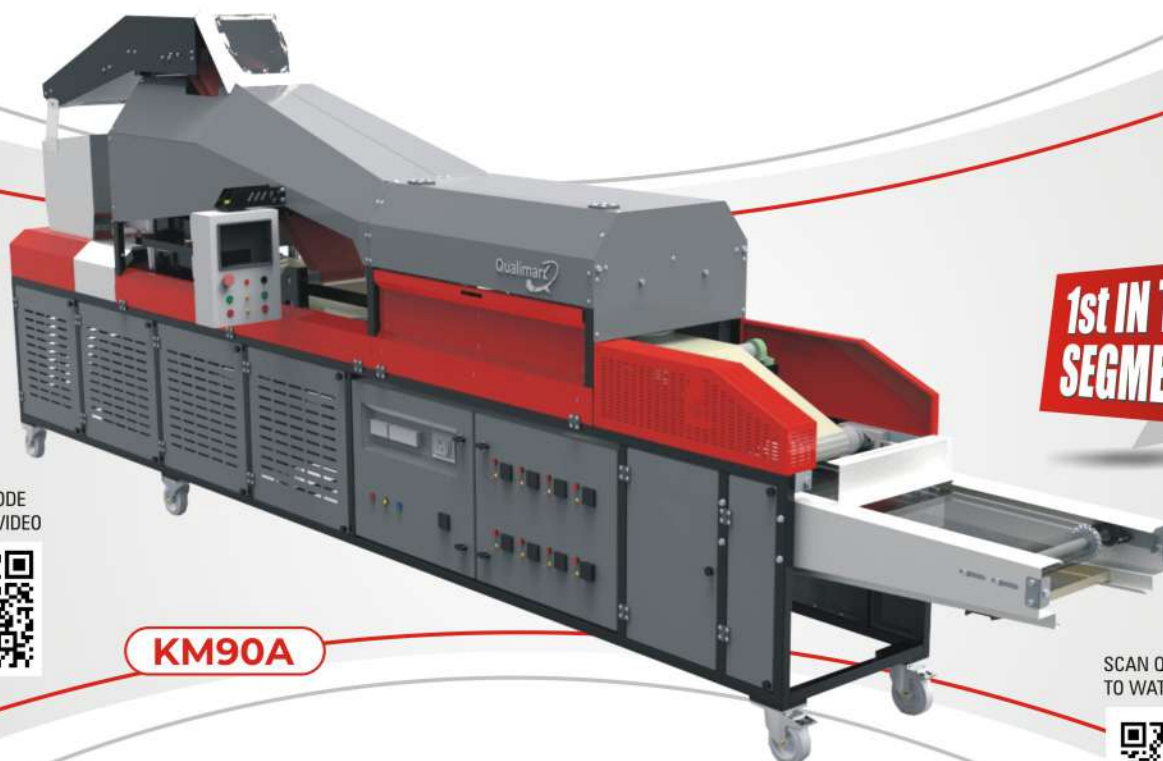

SCAN QR CODE  
TO WATCH VIDEO



**KM90A**

**1st IN THE  
SEGMENT**

SCAN QR CODE  
TO WATCH VIDEO



**KM250A**



## TECHNICAL SPECIFICATION

TYPE	KM90A	KM180A	KM250A
<b>Production Rate (Approx.)</b>	900 Nos. / Hr. 100 Kg / 8 Hr.	1800 Nos. / Hr. 200 Kg / 8 Hr.	2500 Nos. / Hr. 300 Kg / 8 Hr.
<b>Total Elec. Motor (3 Phase)</b>	5 HP	6 HP	7.5 HP
<b>Required Elec. Power (HP / kW) 3 Phase</b>	16.75 HP / 12.48 kW	28.43 HP / 21.18 kW	41.25 HP / 30.73 kW
<b>Belt Alignment System</b>	Automatic	Automatic	Automatic
<b>Roasting Platform</b>	4 Nos.	8 Nos.	12 Nos.
<b>Overall Dimensions (Ft.)</b>	16.75 x 3.55 x 6.20 (L x W x H)	16.75 x 4.35 x 6.20 (L x W x H)	18.35 x 4.35 x 6.20 (L x W x H)
<b>Weight (Kg.) Approx.</b>	1150	2000	2150

## Unique Features of Fully Automatic Khakhra Making Machine



Fully Automatic Machine



Single Operator Required



In Built Dough Ball Making



Automatic Cutting Wastage Collection



HMI Display For Easy Operating & Viewing



Automatic Belt Alignment System



In-built Belt Cleaning System



Hydraulic Chiller



Up To 50% Electricity Saving



India's Highest Capacity Machine



In-house R&D Facility



Less Maintenance

# AUTOMATIC KHAKHRA MAKING MACHINE



**KM90**

SCAN QR CODE  
TO WATCH VIDEO



**KM180**

SCAN QR CODE  
TO WATCH VIDEO



**DOUGH BALL  
(OPTIONAL)\***

## Unique Features of Automatic Khakhra Making Machine



Integrated Dough  
Ball Machine



HMI Display for  
Easy Operating &  
Viewing



Convenient  
Belt Alignment  
System



Hydraulic  
Chiller



Up To 50%  
Electricity Saving



India's Highest  
Capacity Machine



In-house R&D  
Facility



Less Labor  
Requirement



Less  
Maintenance

### TECHNICAL SPECIFICATION

TYPE	KM45	KM90	KM180	KM250
<b>Production Rate (Approx.)</b>	450 Nos. / Hr. 50 Kg / 8 Hr.	900 Nos. / Hr. 100 Kg / 8 Hr.	1800 Nos. / Hr. 200 Kg / 8 Hr.	2500 Nos. / Hr. 300 Kg / 8 Hr.
<b>Total Elec. Motor (3 Phase)</b>	2.5 HP	3.5 HP	4.5 HP	6 HP
<b>Required Elec. Power (HP / kW) 3 Phase</b>	6.87 HP / 5.12 kW	15.25 HP / 11.36 kW	26.93 HP / 20.06 kW	39.75 HP / 29.61 kW
<b>Belt Alignment System</b>	Manual	Manual	Manual	Manual
<b>Roasting Platform</b>	2 Nos.	4 Nos.	8 Nos.	12 Nos.
<b>Overall Dimensions (Ft.)</b>	11.70 x 2.60 x 5.25 (L x W x H)	13.30 x 2.60 x 5.25 (L x W x H)	13.30 x 3.45 x 5.55 (L x W x H)	16.55 x 3.45 x 5.55 (L x W x H)
<b>Weight (Kg.) Approx.</b>	600	750	1000	1400

\*Integrated Dough Ball Machine is only for illustration purpose and sold separately.



# KHAKHRA MAKING MACHINE MECHANICAL MODEL

SCAN QR CODE  
TO WATCH VIDEO



**KM60M**



## TECHNICAL SPECIFICATION

TYPE	KM60M
Production Rate (Approx.)	600 Nos. / Hr. 65 Kg / 8 Hr.
Total Elec. Motor (3 Phase)	1.25 HP
Required Elec. Power (HP / kW) 3 Phase	9.65 HP / 7.12 kW
Belt Alignment System	Manual
Roasting Platform	3 Nos.
Overall Dimensions (Ft.)	7.50 x 2.50 x 4.30 (L x W x H)
Weight (Kg.) Approx.	550

## Unique Features of Automatic Khakhra Making Machine - Mechanical Model



Mechanical  
Based Pressing



Very Compact  
Machine



Less Labor  
Requirement



Less  
Maintenance



Up To 50%  
Electricity Saving



In-house  
R&D Facility

# AUTOMATIC KHAKHRA ROASTING MACHINE

**KR120**

SCAN QR CODE  
TO WATCH VIDEO



**KR90**



## TECHNICAL SPECIFICATION

TYPE	KR45	KR60	KR90	KR120	KR150
<b>Production Rate (Approx.)</b>	450 Nos. / Hr.	600 Nos. / Hr.	900 Nos. / Hr.	1200 Nos. / Hr.	1500 Nos. / Hr.
<b>Elec. Motor (3 Phase)</b>	1HP	1HP	1HP	1HP	1HP
<b>Required Elec. Power (HP / kW) 3 Phase</b>	17.12 HP / 12.75 kW	22.48 HP / 16.75 kW	33.22 HP / 24.75 kW	43.96 HP / 32.75 kW	54.69 HP / 40.74 kW
<b>Roasting Platform</b>	6 Nos.	8 Nos.	12 Nos.	16 Nos.	20 Nos.
<b>Overall Dimensions (Ft.)</b>	5.2 x 5.8 (D x H)	5.2 x 5.8 (D x H)	5.93 x 5.8 (D x H)	7.2 x 5.8 (D x H)	8.2 x 5.8 (D x H)
<b>Weight (Kg.) Approx.</b>	420	500	700	850	1000

## Unique Features of Automatic Khakhra Roasting Machine



Drop Down  
Roasting  
Dish Design



Easy Khakhra  
Handling

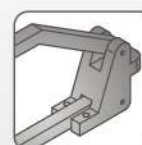

In-house  
Designed Solid  
MS Hinge



Convenient  
Machine Speed  
Adjustment



Oil Dropping  
System



Excess Oil  
Collection Tray



In-house  
R&D Facility



Very Compact  
Machine



Less  
Maintenance



# DOUGH BALL MAKING MACHINE

**NEW  
DESIGN**

# FLOUR KNEADING MACHINE



**DB**

SCAN QR CODE  
TO WATCH VIDEO



**FK10**

SCAN QR CODE  
TO WATCH VIDEO



## TECHNICAL SPECIFICATION

TYPE	DB10E	DB20E
Production Rate (Approx.)	Up to 1000 Nos. / Hr.	Up to 2000 Nos. / Hr.
Weight of Dough Ball	25 to 60 Gms.	20 to 60 Gms.
Required Elec. Power (HP / kW) 1 Phase	0.75 HP / 0.55 kW	0.75 HP / 0.55 kW
Dough Ball Cutting Technology	Electric Motor with Blade Technology (Pneumatic Version is also available)	
Overall Dimensions (Ft.)	2.70 x 1.40 x 5.40 (L x W x H)	
Weight (kg.) Approx.	145	

## TECHNICAL SPECIFICATION

TYPE	FK10	FK20	FK30
**Production Rate/Batch	10 Kg.	20 Kg.	30 Kg.
Elec. Motor	1 HP Single / 3 Phase	1.5 HP Single / 3 Phase	2 HP Single / 3 Phase
Required Elec. Power (HP / kW) - 1 Phase	1 HP / 0.75 kW	1.5 HP / 1.12 kW	1.5 HP / 1.12 kW
Overall Dimensions (Ft.)	3.00 x 1.60 x 2.60 (L x W x H)	3.44 x 2.30 x 3.44 (L x W x H)	4.43 x 2.95 x 3.94 (L x W x H)
Weight (Kg.) Approx.	125	135	145

**\*\*1 Batch Time = 15 to 20 Minutes**

## Unique Features of Dough Ball Making Machine



Worm Made of Food Grade Material



Easy Dough Ball Size Adjustment



Easy To Integrate with Other Machines



Variable Output Capacity



Smooth & Precise Dough Ball Cutting



Very Compact Machine



In-house R&D Facility



Less Maintenance



Easy to Clean



# VACUUM PACKAGING MACHINE

SCAN QR CODE  
TO WATCH VIDEO



**VPS**



**VPD**

# SHRINK PACKAGING MACHINE



**SP1**



**SP2**



SCAN QR CODE  
TO WATCH VIDEO



SCAN QR CODE  
TO WATCH VIDEO



## TECHNICAL SPECIFICATION

TYPE	VPS11 Single Chamber	VPS34 Single Chamber	VPD Double Chamber
Chamber Size (Ft.)	1.28 x 0.95 x 0.17 (L x W x H)	1.44 x 1.37 x 0.32 (L x W x H)	1.80 x 1.64 x 0.22 (L x W x H)
Sealing Length	260 mm	500 mm	500 mm
Sealing Width	10 mm	12 mm	5 mm
Elec. Consumption	2 kW / Hr.	2.5 kW / Hr.	2.5 kW / Hr.
Overall Dimensions (Ft.)	1.65 x 1.15 x 1.15 (L x W x H)	2.20 x 1.80 x 3.28 (L x W x H)	2.13 x 4.59 x 2.62 (L x W x H)
Weight (Kg.) Approx.	100	105	225

## TECHNICAL SPECIFICATION

TYPE	SP1 Table Top	SP2 Leg Type
Tunnel Dimensions (Ft.)	1.41 x 0.32 x 0.32 (L x W x H)	3.93 x 2.13 x 2.95 (L x W x H)
Heater	3 kW	6 kW
Conveyor Speed	Variable Max. 4 Mtr. / Min.	Variable Max. 8 Mtr. / Min.
Mechanical Dimensions (Ft.)	2.45 x 1.47 x 2.06 (L x W x H)	3.95 x 2.46 x 2.92 (L x W x H)

## CLIENTELE

We are proud to work with the best in the business. We have extensive experience in each area we service and focus on customer and client satisfaction throughout each part of the process. Qualimark takes a responsible approach to each project working closely with our clients and work towards a long-term relationship, providing solutions for now and the future.

### School / College / Institute



Navrachana  
International School  
Vadodara



### Government / Hospital / Temple / NGO's / Trust



### Corporates / Industrial / Commercial



### Khakhra Manufacturers / Food Processor



### Hotels & Restaurants



and it continues...

we are proud to have them "satisfied"



## DOMESTIC PRESENCE

We have been manufacturing these machines for **22 Years** and have already installed more than **1000+** machines across the Globe. Our successful installations are in more than **27 States** in **India** and in **28 Countries** across the Globe like...

USA, Canada, UK, Switzerland, New Zealand, Singapore, Thailand, Bangladesh, Nepal, Qatar, Oman, UAE, Israel, South Africa, Ghana, Zambia, Kenya, Botswana, Tanzania, Brunei, China, Iraq, Australia, Mauritius & Saudi Arabia, Sri Lanka, Maldives & Bahrain.



## QUALIMARK PRODUCTS

Chapati, Khakhra, Tortilla & SPM Machinery

## GLOBAL PRESENCE



*Where Quality Meets Expectations*

### Qualimark Machines Pvt. Ltd.

#### Registered Office & Mfg. Unit :

- Plot No. 229/A/1 & 229/B/1, Por Industrial Park, NH-8, Por, Tal.-Vadodara, Dist.-Vadodara, Gujarat-391243 (India)
- +91 75748 67420 | 94282 96969
- sales@qualimark.in | www.qualimark.in



Scan QR code to visit our website



Scan QR code to watch product videos

